

# 38749 Hochbordwagen D&RGW D&RGW High-Side Gondola

## ERSATZTEILE

Spare parts · Pièces détachées · Reserveonderdelen

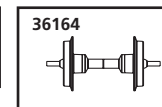
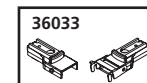
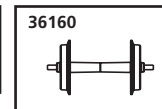
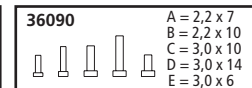
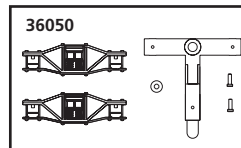
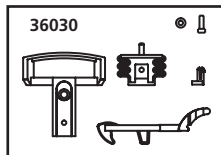
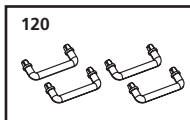
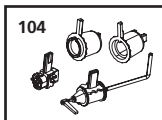
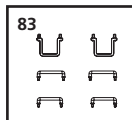

Nr:	Description:	Bezeichnung:	Désignation:	Beschrijving:	PG*
38715-83	Handrails, Steps	Griffstangen, Aufstiegstritt	Handrails	Handgrepen, Trede	9
38715-104	Air Cylinder / Brake cylinder / Control valve	Luftkessel / Bremszylinder / Stellventil	Citerne à air / Cylindre de frein / Valve	Luchtketel / Remcilinder / Regelklep	10
38749-120	Handrails (4 Pcs)	Griffstangen (4 Stück)	Handrails (2 unités)	Handgrepen (4 stuks)	8
	<b>Spare parts, standard range</b>	<b>Standard Ersatzteile</b>	<b>Pièces détachées standard</b>	<b>Standaardonderdelen</b>	
36030	Standard Coupler	Kupplung komplett	Attelage, complet	Koppeling, volledig	
36033	Rigid Coupler	Ganzzug-Kupplung	Attelage	Koppeling	
36050	Arch Bar Truck Frame (set of 2)	Drehgestell Arch Bar (2 Stück)	Bogy (2 unités)	Draaistel (2 stuks)	
36090	Screws (5 Sizes, 20 Pcs)	Schrauben-Set (20-tlg./5 Größen)	Jeu de vis (20 pièces, 5 tailles)	Set schroeven (20-delig)	
36160	Plastic Wheelset (set of 2)	Radsatz Kunststoff (2 St.)	Essieux plastiques (2 unités)	Kunststof wielstel (2-delig)	
36164	Metal Wheelset (set of 2)	Radsatz Metall (2 St.)	Essieux métalliques (2 unités)	Metalen wielstel (2-delig)	

\*Preisgruppe \*price category \*catégorie de prix \*Priscategorie